

Gluing BerryAlloc Wall&Water panels on an existing solid wall

This installation procedure requires that the underlying wall is dry ($RH < 85\%$ / $CM < 2\%$), has good adhesion and complies with the requirements for directional and surface tolerances. Use a primer for good adhesion, if necessary. Make sure the walls are clean, straight and even and that all corners are perpendicular. Any deviation must be rectified before installation.

Additional equipment needed: BerryAlloc Adhesive or PU foam adhesive, BerryAlloc screws and wall plugs and drills ($\varnothing 2$ mm and additionally in the same size as the wall plugs). Wall plugs are illustrated in picture 2.

Read and get in details familiar with the general installation instructions for BerryAlloc Wall&Water panels (to be downloaded from www.berryalloc.com). Make sure that you understand the installation instructions.

This document is only supplementary information when BerryAlloc Wall&Water panels are to be attached to a solid wall, like concrete.

Description:

Install the base profiles perfectly in level. Use BerryAlloc Adhesive on the backside of the base profile and fix it to the wall with wall plugs and BerryAlloc screws. Use in addition BerryAlloc Sealant for all sealing as described in the general installation instructions for BerryAlloc Wall&Water panels.

Install the inner corner profiles perpendicularly with the help of BerryAlloc adhesive, wall plugs and BerryAlloc screws.

- 1) Position the W&W panel (w/o glue) on the base profile. Drill 3 small holes through the locking profile of the panel and into the solid wall, for marking the position of the holes for the wall plugs (position as shown in the illustration, the third one in the middle).

- 2) Remove the W&W panel and widen the holes. Place wall plugs into the 3 holes.

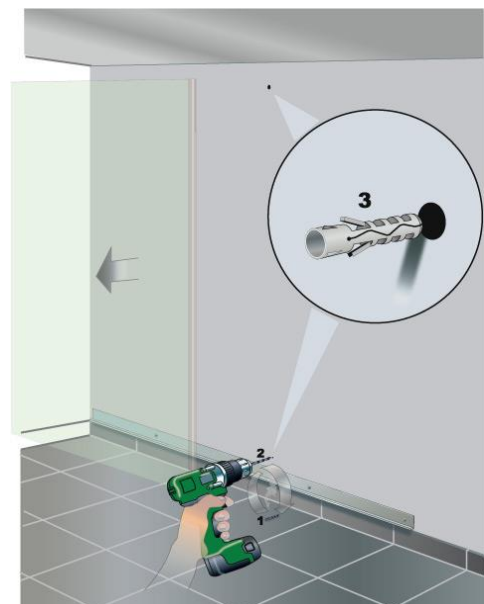
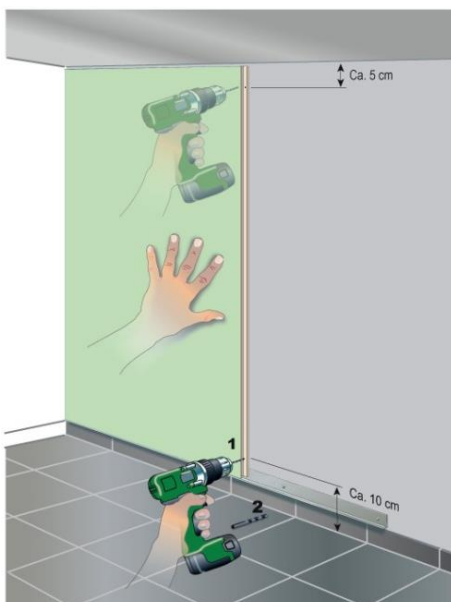

Doc.no: LA-1710-1EN	Date: 28.07.2023
Replaces: LA-1309-1EN	Page: 2 of 2

- 3a) Walls with max. deviation of 5 mm per 2 m
Apply BerryAlloc Adhesive as wide stripes on the wall in the width of the panel (min. 6 stripes, as shown in the illustration)

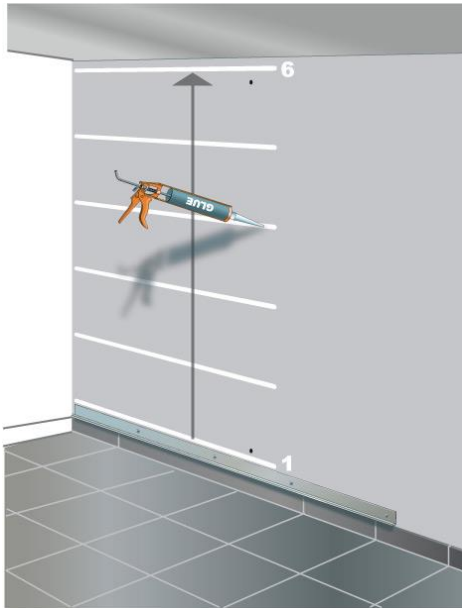

- 3b) Walls with max. deviation 12 mm per 2 m
Apply PU foam adhesive on the back side of the panel and directly on the wall, if necessary.

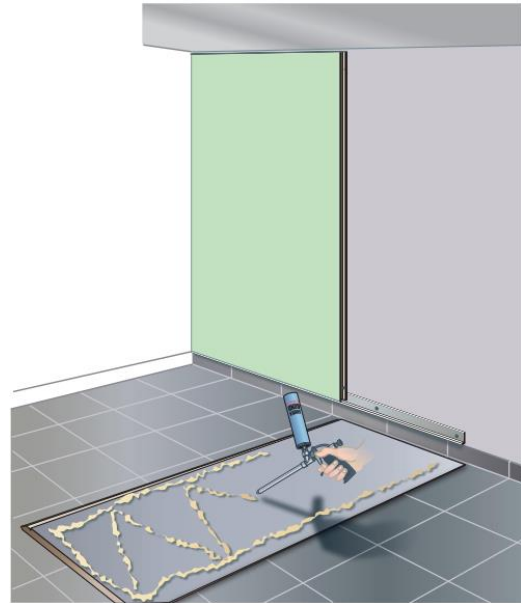

- 4) Re-position the W&W panel (w/adhesive).
Put pressure on the panel and fasten the W&W panel to the wall with BerryAlloc screws, by using the pre-drilled holes in the locking profile.

